

coway
AIRMEGA

USER MANUAL

Air Purifier Airmega 100

EN/DE/FR/IT/ES/NL/SV/DA/NB/FI

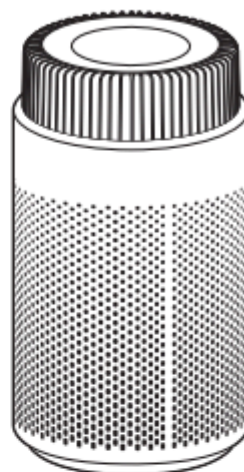

coway

KEY FEATURES



Small, but powerful air purifier

Reduced size, enhanced air purification capacity for bedroom use. Sleep mode minimizes the airflow noise to avoid annoyance in bedroom settings.



Powerful 3-in-1 Filter

True HEPA H13 Filter efficiently filters various harmful sources and captures 99.97% of nano-sized particulate matter down to 0.03 micrometers.



Light display

AQI Lighting: Intuitively indicates the air quality.
Night light: Soothing night light for bedroom usage.

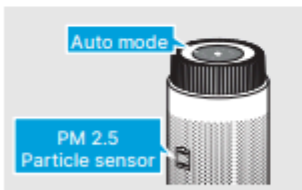

Smart sensor and automatic mode

The PM 2.5 sensor accurately measures the level of ultra-fine dust. The AQI and auto mode adjusts the airflow speed (1, 2, and 3) for optimal operation depending on the indoor air quality.



Energy Star certified air purifier

Eco Friendly air purifier with low energy consumption.

QUICK START GUIDE

Do not operate the product until completing these steps first.

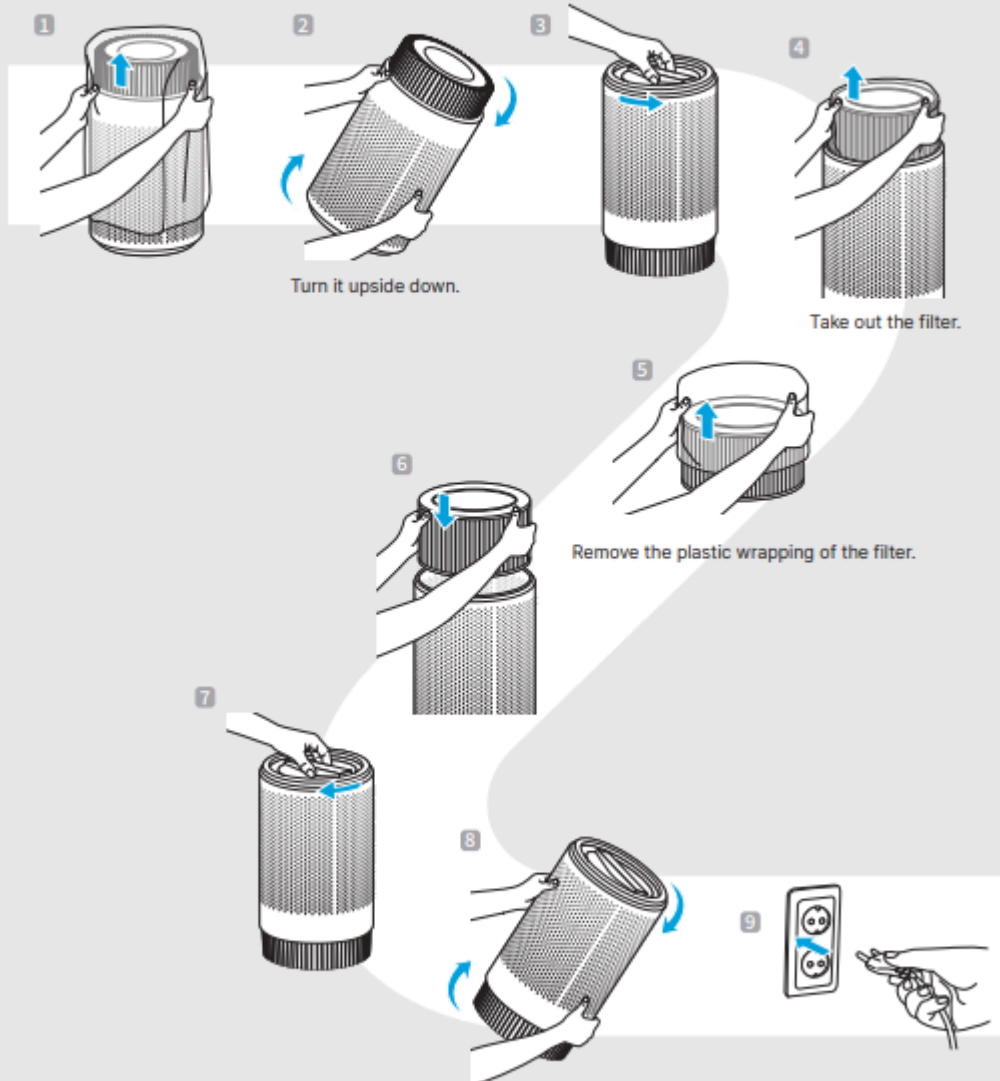

PARTS DIAGRAM

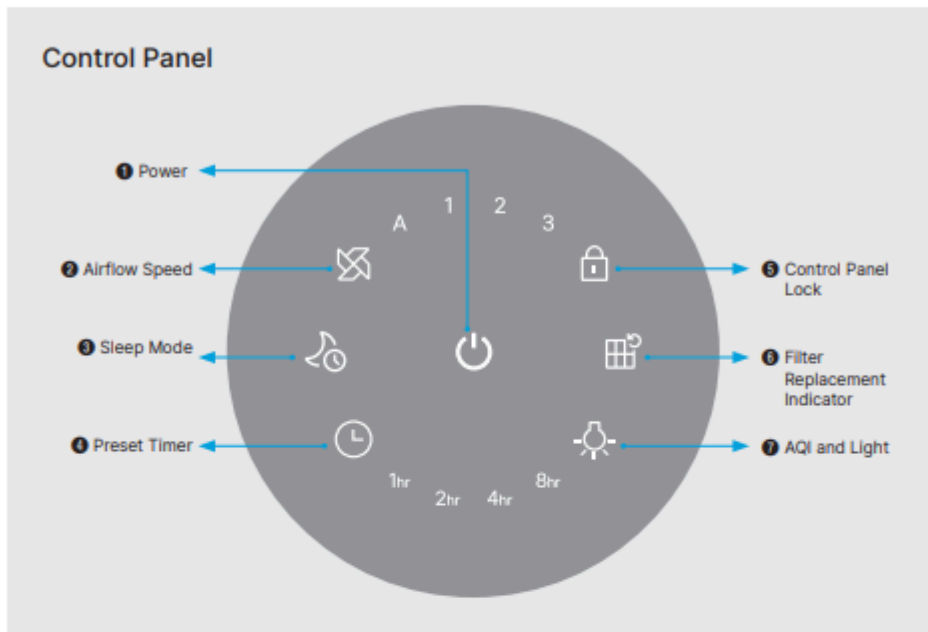

CONTROL PANEL



1 Power

Press the  button to turn the product on and off.



2 Airflow Speed

Press the  button to switch the mode.
"A" (auto), "1"(low), "2"(Med),"3"(high)







3 Sleep Mode

If the product is set to sleep mode, it reduces noise and power consumption.

Press the  button while power is on to enter the Sleep mode.

In the Sleep Mode, the fan speed is reduced for low noise operation in order not to interrupt the user's sound sleep.

Also, brightness of the  button and  button (if timer is operating, the  button and  button) on the display panel is restricted to 50 %.

If you press the  button once again, it returns to the previous air speed.



4 Preset Timer

Touch the  timer button until the indicator light displays the desired time.

When pressing the button, it is set in the order of 1hr → 2hr → 4hr → 8hr → OFF, and the set time is displayed on the display panel.

USE OF EACH FUNCTION BUTTON





5 Control Panel Lock

Press and hold the button for 3 seconds to lock and unlock when power is turned on. When pressing another button while the product is locked, the button indicator blinks three times with a beep sound and the button does not operate. When pressing and holding the  button again for 3 seconds in the Lock mode, the Lock mode is deactivated and the button turns off. If the power cord is plugged in after removed, or if the power of the product is turned on after off by the timer, lock is deactivated automatically.



6 Filter Replacement Indicator

 will pop up on the display panel when its time to replace the filter. After replacing the filter, press and hold the  for 3 seconds to reset the filter replacement indicator.



7 AQI and Light

Press the  button to switch between AQI and night light or to turn off the light.

According to the air quality, the color of AQI light changes.

- **Blue: Good, Green: Moderate, Orange: Unhealthy, Purple: Very Unhealthy**

In the default operation status, the button and AQI indicator are displayed in maximum brightness on the display panel.

When pressing the button, AQI indicator, Night Light and off functions are alternately performed.

AQI mode → Night light → All off → AQI mode

PRODUCT CLEANING

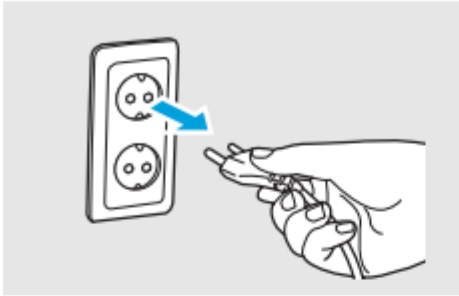

- 1 Before cleaning the product, please be sure to turn off the power and unplug the machine.



- 2 Use a dry cloth to clean the product. Do not use detergents that contain solvents, thinners, bleach, chlorine, or abrasives.

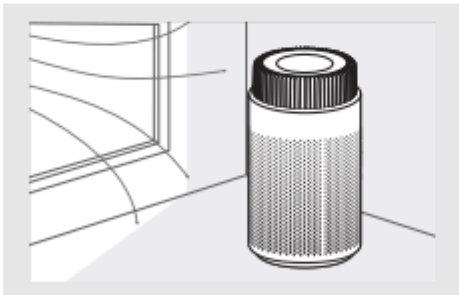

- 3 Place the product in a well-ventilated shade.

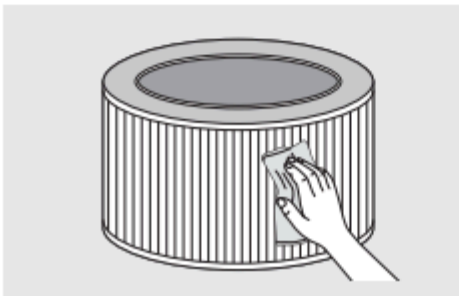

- 4 Gently brush off the collected dust on the surface of the prefilter with dry cloth, or vacuum cleaner for optimal performance.

FILTER REPLACEMENT INSTRUCTION



- 1 Unplug the product and turn the product upside down to replace the filter.

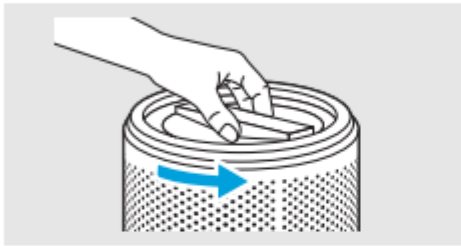

- 2 Grab the handle and turn clockwise to close and turn counter clockwise to open the rear cover.

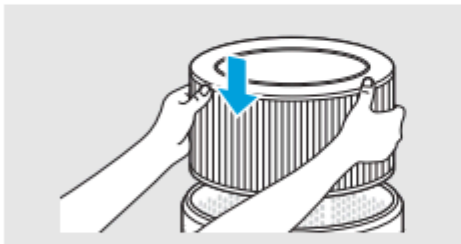

- 3 Please take the used filter out and replace with a new filter.

PARTICLE SENSOR CLEANING (CLEAN EVERY 2 MONTHS)

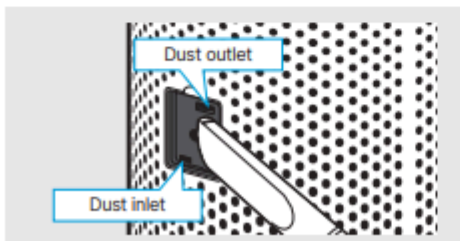

If there are dusts or foreign objects in the particle sensor, the dust density may be detected high, so clean periodically to remove the dust.

- * If not cleaned periodically, the particle sensor performance will be degraded.
- * The cleaning cycle may differ depending on the environment. Clean more often in very dusty environments.
- * Do not let dusts drop into the air vent hole when you clean it.

1. Use a vacuum cleaner or soft brush to clean the dust outlet and dust inlet.

* Use the lowest power of the vacuum cleaner to clean.

2. Clean the dust outlet and dust inlet with wet cotton swab, then wipe it off with dry cotton swab to remove moisture from it.

SPECIFICATION

The specification is subject to minor changes to improve the product performance.

Product type	Air Purifier
Model Name	Airmega 100
Filter	3 in 1 Filter (Pre-Filter + True HEPA Filter + Deodorization Filter)
Airflow	4 Stages (Auto - 1 - 2 - 3)
Timer	On/Off Timer up to 8 hours
Voltage / Frequency	220 V - 240 V~ 50-60 Hz
Power Consumption	25 W
Dimension (W x H x D)	Filter: Φ 19.3 x 14.8 cm Product: 22 x 22 x 39.5 cm
Product Weight	Product weight: 3.0 kg Gross weight: 4.0 kg

► Product design and specification may change without any prior notice for application of statutes, product improvement, and quality enhancement.